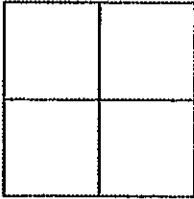

Document Number CR 1074City of BERKELEYCounty of ALAMEDA, CaliforniaBrief Legal Description MONUMENT ON STERLING AVENUE APPROX. 220' WEST  
OF THE INTERSECTION OF SHASTA ROAD AT STREET ADDRESS 1184**CORNER RECORD**

Government Corner ☐ Control ☐  
 Meander ☐ Property ☐  
 Rancho ☐ Other ☒  
 Date of Survey 8-18-98

**COORDINATES**  
(Optional)

N. \_\_\_\_\_  
 E. \_\_\_\_\_  
 Zone \_\_\_\_\_ Datum \_\_\_\_\_  
 Elev. \_\_\_\_\_

Corner — Left as found ☒ Found and tagged ☐ Established ☐ Reestablished ☐ Rebuilt ☐

In conformance with Section 8771 of the Professional Land Surveyors' Act this corner record is being filed to  
 ESTABLISH X / REESTABLISH \_\_\_\_\_ the position of an existing monument PRIOR X / SUBSEQUENT \_\_\_\_\_  
 to street or highway reconstruction.

Identification and type of corner found: Evidence used to identify or procedure used to establish or reestablish the corner:

STANDARD CITY OF BERKELEY STREET MONUMENT, WITHIN ROADWAY.

A description of the physical condition of the monument as found and as set or reset: \_\_\_\_\_

MONUMENT WAS REFERENCED;

MONUMENT WILL BE REMOVED DURING CONSTRUCTION AND RESET AFTER

CONSTRUCTION IS COMPLETE.

**SURVEYOR'S STATEMENT**

This Corner Record was prepared by me or under my direction in conformance with  
 the Land Surveyors' Act on SEPTEMBER 7 19 98.

Signed Vincent H. Cunha L.S. Number LS 4520

**COUNTY SURVEYOR'S STATEMENT**

This Corner Record was received 11-13-1998 and examined  
 and filed 11-6-1999

Signed Russell R. Penland, Jr. Title County Surveyor

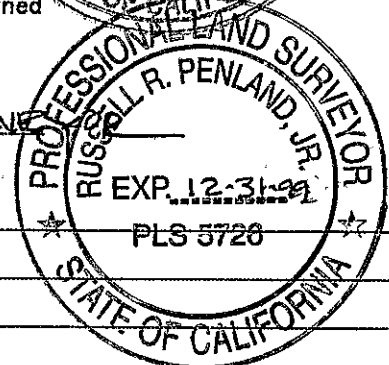

County Surveyor's Comment \_\_\_\_\_

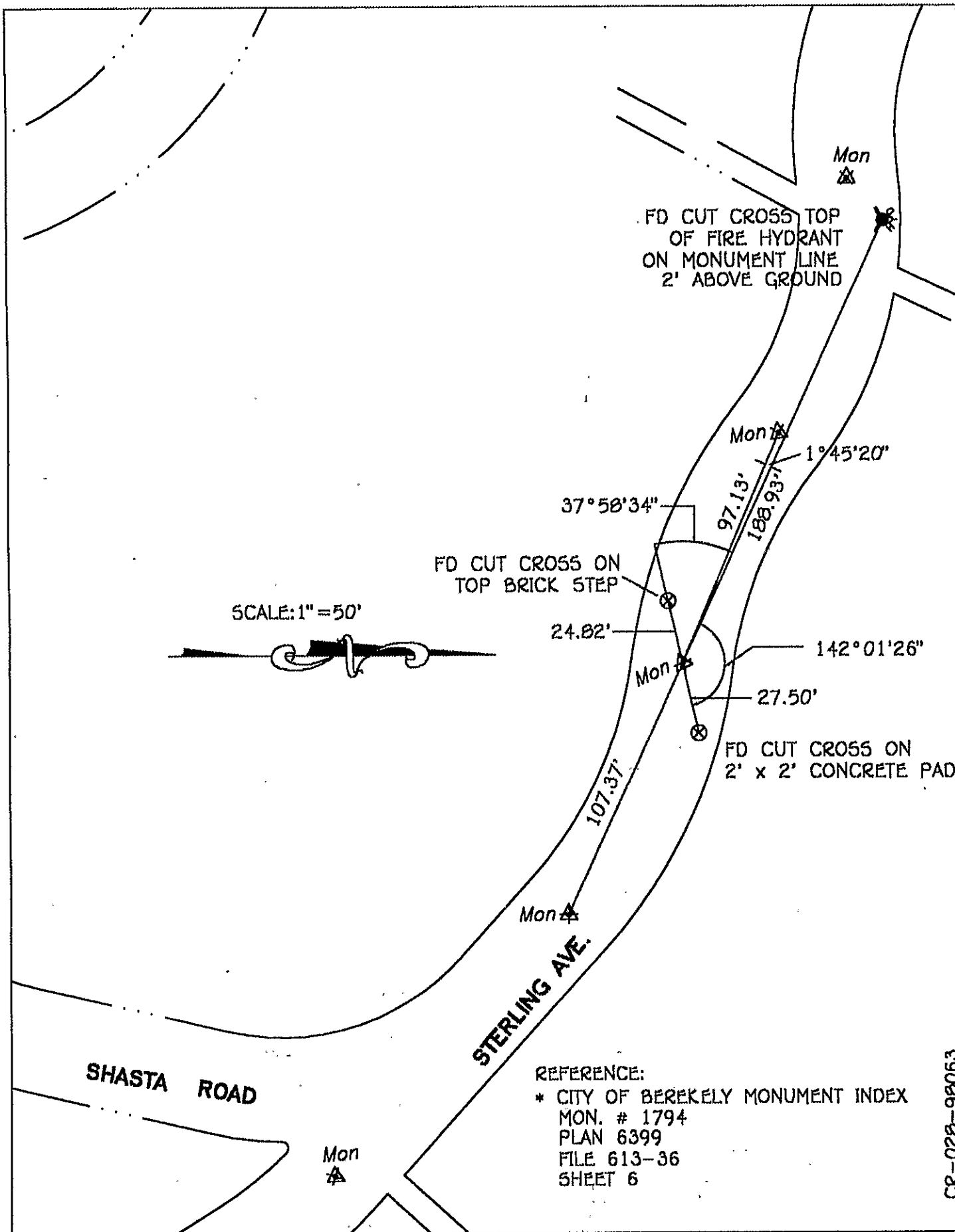

CR-028-98063