

CORNER RECORD

APN No. 056-1972-005-00 (Optional) Document Number CR 3435
City of BERKELEY County of ALAMEDA, California
Brief Legal Description MONUMENT REFERENCE AT INTERSECTION OF UNIVERSITY AVENUE
AND NINTH STREET

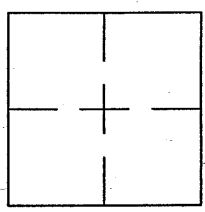

CORNER TYPE

Government Corner ☐ Control ☒
Meander ☐ Property ☐
Rancho ☐ Other ☐
Date of Survey AUGUST 06, 2008

COORDINATES

(Optional)

N. _____
E. _____
Zone _____ Datum _____
Elev. _____

Corner - Left as found ☒ Found and tagged ☐ Established ☐ Reestablished ☐ Rebuilt ☐

In compliance with Section 8771 of the Professional Land Surveyors' Act, this corner record is being filed to
ESTABLISH _____ / REESTABLISH X the position of an existing monument PRIOR _____ / SUBSEQUENT X
to street or highway reconstruction. (Use this portion only when applicable.)

Identification and type of corner found: Evidence used to identify or procedure used to establish or reestablish the corner:
VERIFIED EXISTING CITY OF BERKELEY MONUMENT B0505 SUBSEQUENT TO
STREET IMPROVEMENT

A description of the physical condition of the monument as found and as set or reset: _____
VERIFIED CUT CROSS ON SIDEWALK AS SHOWN ON DOCUMENT NUMBER CR 3122 (BK-27 PG-83)

SURVEYOR'S STATEMENT

This Corner Record was prepared by me or under my direction in conformance with
the Land Surveyors' Act on Sept. 16 20 08.
Signed [Signature] L.S. or R.C.E. Number 5797

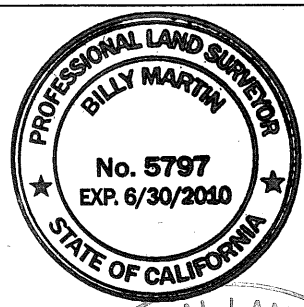

COUNTY SURVEYOR'S STATEMENT

This Corner Record was received 8-8 20 08 and examined
and filed 9-21- 20 08
Signed [Signature] Title: County Surveyor

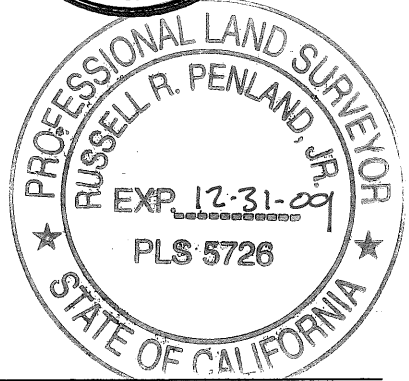

County Surveyor's Comment _____

