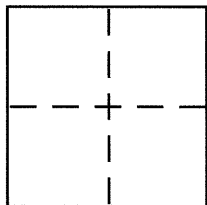

CORNER RECORDBK 82 PG 99Document Number CR 8620City of Hayward County of ALAMEDA, CaliforniaBrief Legal Description Iron Pipe @ Laurel Ave & Meekland Ave**CORNER TYPE**

Government Corner ☐ Control ☒
Meander ☐ Property ☐
Rancho ☐ Other ☐
Date of Survey July 6 2016

COORDINATES (Optional)

N. SEE PAGE 2
E. SEE PAGE 2
Zone NAD27 ☐ NAD83 ☒
NAD83 Epoch
Elev.
Vert. Datum: NGVD29 ☐ NAVD88 ☐
Meas. Units: Metric ☐ Imperial ☐

Corner – Left as found ☒ Found and tagged ☐ Established ☐ Reestablished ☐ Rebuilt ☐

Identification and type of corner found: Evidence used to identify or procedure used to establish or reestablish the corner:

PER SECTION 8771b OF THE BUSINESS AND PROFESSIONS CODE
THIS MONUMENT WAS REFERENCED PRIOR TO A CONSTRUCTION
PROJECT IN THE VICINITY.

A description of the physical condition of the monument as found and as set or reset:

MONUMENT WAS FOUND IN GOOD CONDITION

SURVEYOR'S STATEMENT

This Corner Record was prepared by me or under my direction in conformance with

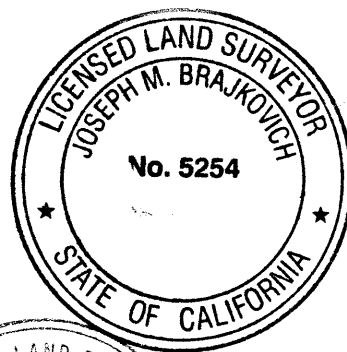
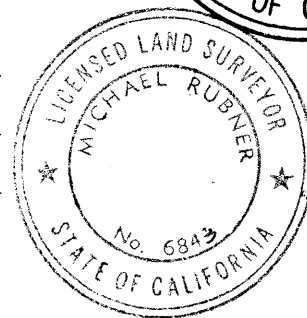
the Land Surveyor's Act on July 17, 2016Signed Joseph Brajkovich P.L.S or R.C.E. No. PLS 5254**COUNTY SURVEYOR'S STATEMENT**This Corner Record was received 2 AUGUST, 2016and examined and filed 24 AUGUST, 2016Signed Michael Rubner P.L.S or R.C.E. No. 6843Title COUNTY SURVEYOR

County Surveyor's Comment _____

